

COLLIN COLLEGE

Standard Response Protocol

Register at www.collin.edu to receive CougarAlerts via texts, phone and e-mail

LOCKDOWN

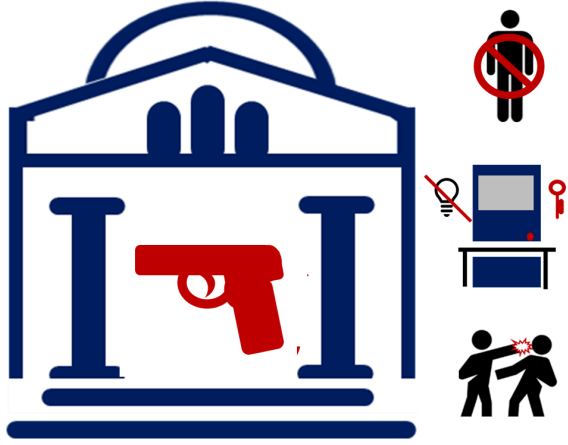

- **AVOID**- go to a safer location
- **DENY**- “Locks, Lights, Out of Sight”
- **DEFEND**- Distract the intruder to get away or defend yourselves

Warn others and call 972.578.5555 with any information for Police

SHELTER



Find a designated place in the building

- Stay away from glass doors, windows, drop, and cover
- Go to the lowest level of the building
- Monitor media sources for official communication
- Wait for additional information from campus officials

EVACUATE

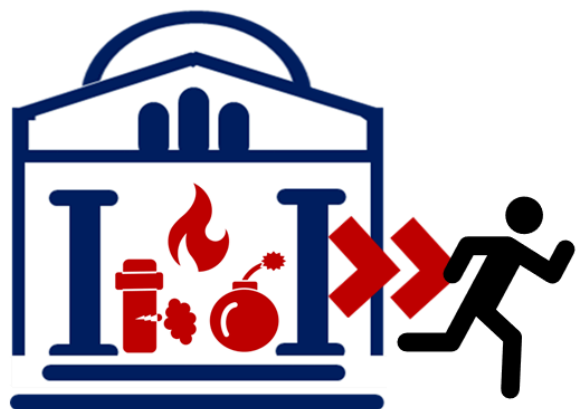

Leave the building IMMEDIATELY

- Take your cell phone
- Assemble 300 feet from building, or as directed
- Call 911 and/or 972.578.5555
- Go outside the building while showing hands
- Wait for additional information from campus officials

HOLD



Clear the halls, hold in your room or area

- Remain in your room or area until all clear is announced
- Close and lock the door
- Wait for additional information from campus officials

